

About Belkorp

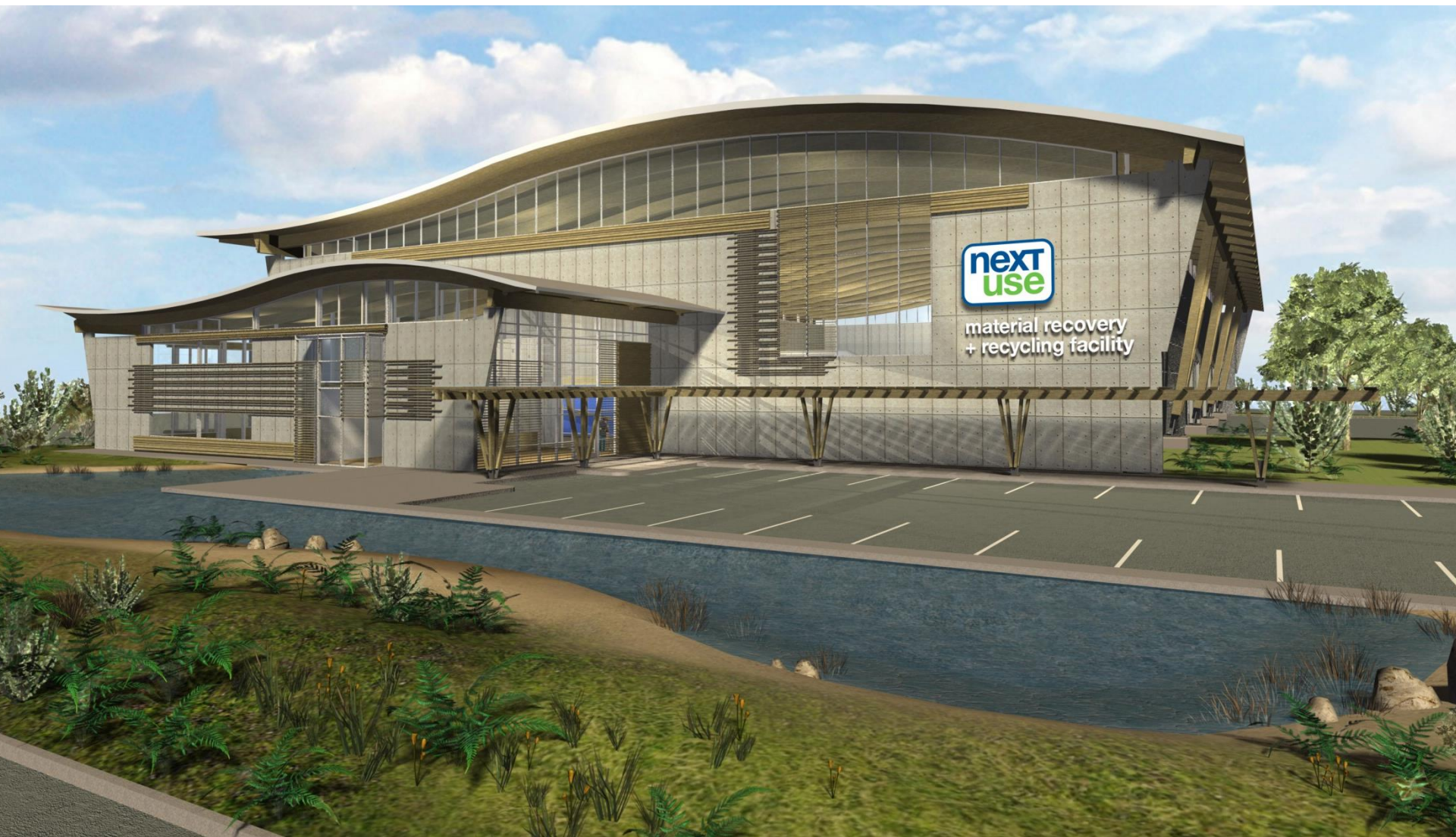

NextUse Recycling Ltd. is a Belkorp group company





next
use

the modern MRF

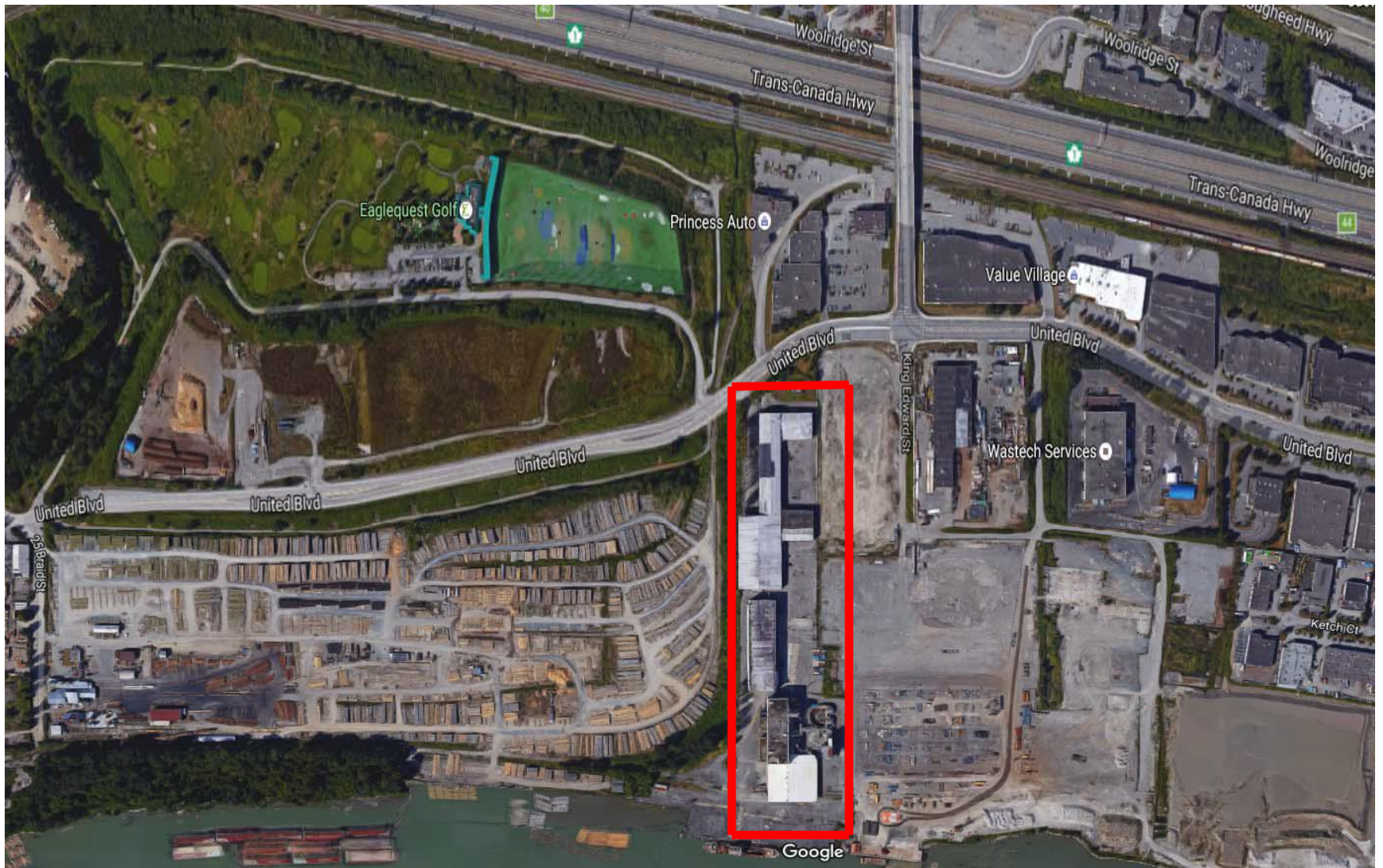





next
use

Proposals

- Negotiation protocol sent to prospective bidders
- Explicit criteria set out for waste diversion
- 4 proposals received
- Pacific Blasting and Demolition were the successful bidder

Recycling and Waste Management Plan

- Burning and burying prohibited
- Required to salvage, reuse, divert to recycling or otherwise avoid landfill/incinerator
- Waste audit and proof of delivery of recycled materials
- Dimensional lumber must be deconstructed to preserve the wood for reuse:
 - Option 1: Stack by size and store where directed by BESI, onsite; or
 - Option 2: Arrange for resale with deduct from the contracted price

Diversion Rate

Material	Weight (lbs)
Diverted	
Stainless Steel	1,413,660
Steel	7,831,099
Aluminum	71,653
Copper	179,000
Wood	5,140
Batteries	2,707
Drywall	29,106
	<hr/>
	9,532,365
Residue	250,820
Overall Total	9,783,185
% Diverted	97%

Time Lapse Video



burnaby_timelapse_final_640x360.mp4



Thank you.



Russ Black, P.Eng.
Vice President, Corporate Development
Belcorp Environmental Services Inc.
rblack@belcorp.com